

Campus-Routenplaner

Praxis der Software-Entwicklung

Lars Gottesbüren · Sascha Gritzbach · Michael Hamann

INSTITUT FÜR THEORETISCHE INFORMATIK · LEHRSTUHL ALGORITHMIK





Campus-Routenplaner

From: **AUDIMAX**

To:

Get directions





Campus-Routenplaner

From: **AUDIMAX**

To: **50.34**

Get directions





Campus-Routenplaner

From: **AUDIMAX**

To: **50.34**

Get directions





Campus-Routenplaner

From: **AUDIMAX**

To: **50.34, Raum 318**

Get directions

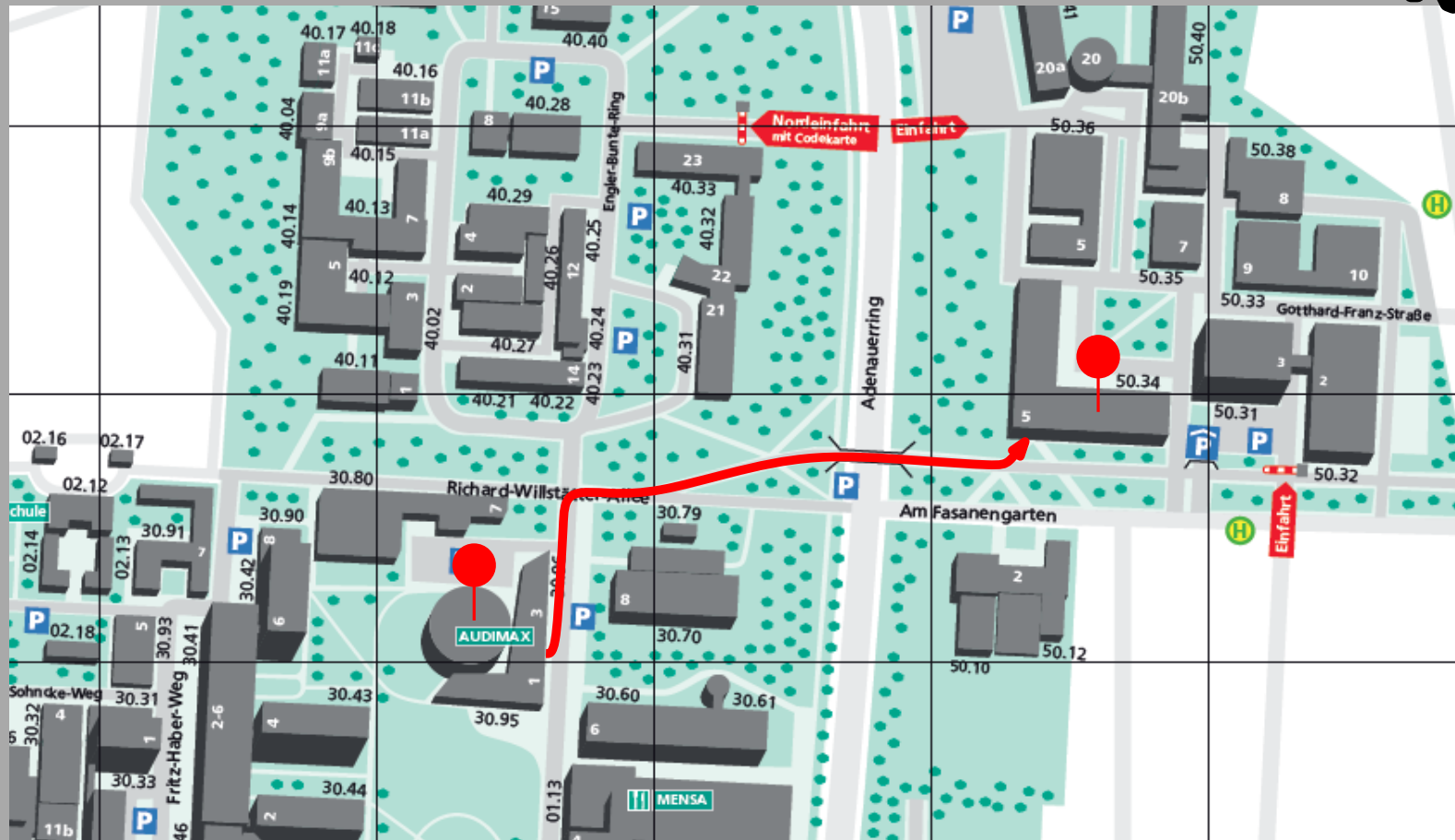



Campus-Routenplaner

From: **AUDIMAX**

To: **50.34, Raum 318**

Get directions

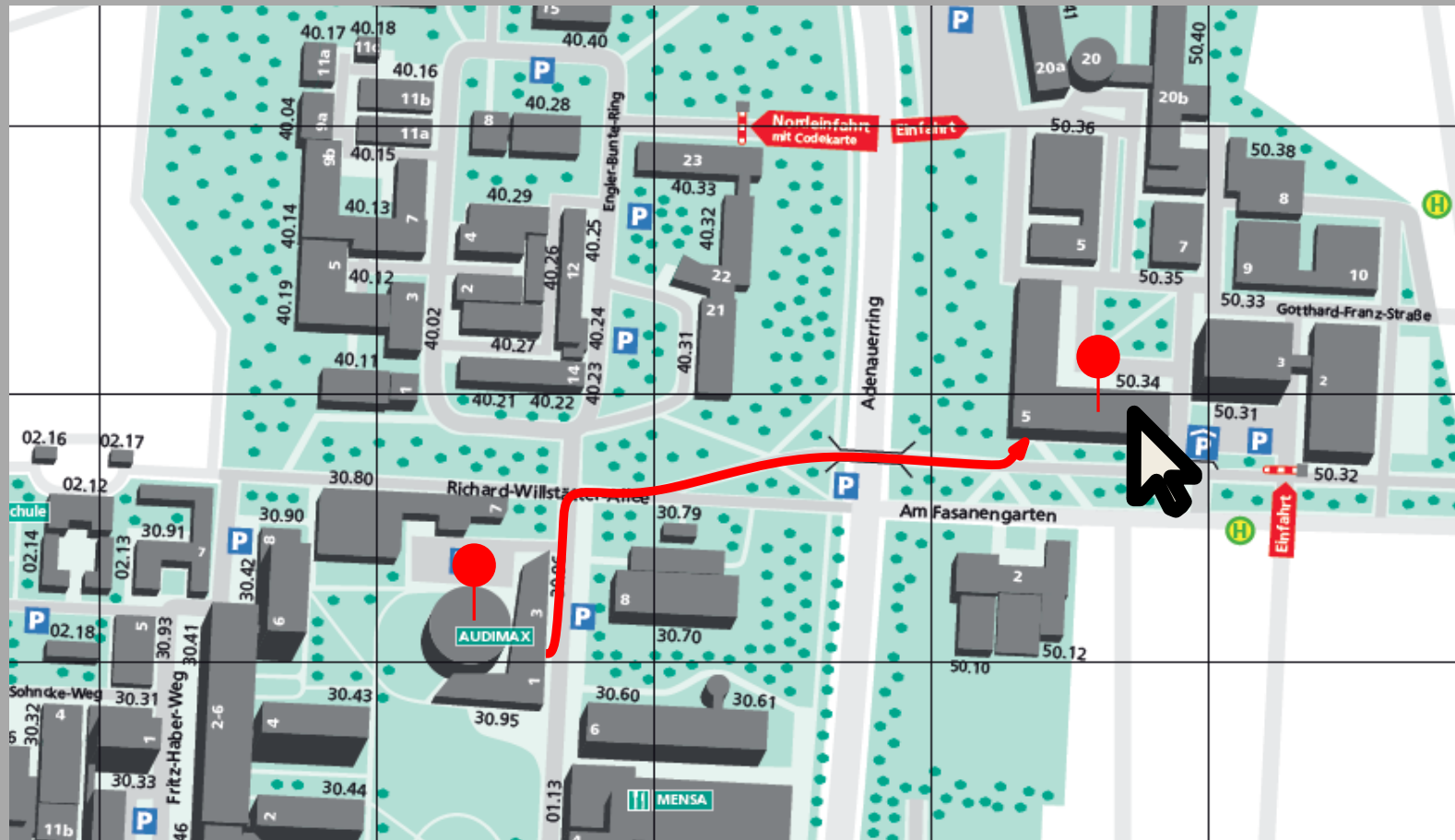



Campus-Routenplaner

From: **AUDIMAX** To: **50.34, Raum 318** [Get directions](#)

Etage 0

The floor plan shows a route starting from the entrance (Eingang) on the left, moving through a hallway, passing a staircase (Treppe) and a BMZ (Büro-Möbelzone), and ending in room 001c. The route is highlighted in red. Other rooms shown include 004, 005, 006, 007, 008, 009, 034, 035, 036, 037, 038, 039, 040, 041, 046, 001a, 001b, 001c, and 002.



Campus-Routenplaner

From: **AUDIMAX** To: **50.34, Raum 318** [Get directions](#)

Etage 0

The floor plan shows a route starting from the entrance (Eingang) on the left, moving through a staircase (Treppe) area, and ending at room 001c in the Bibliothek. The route is highlighted in red. The plan includes rooms 009-004, 037-040, 034-041, 046, 001c, 001a, 001b, 002, and a staircase (Treppe). A BMZ (Büro-Möbelzone) is also marked.



Campus-Routenplaner

From: **AUDIMAX**

To: **50.34, Raum 318**

Get directions

Etage 0

- Etage -2
- Etage -1
- Etage 0
- Etage 1
- Etage 2
- Etage 3

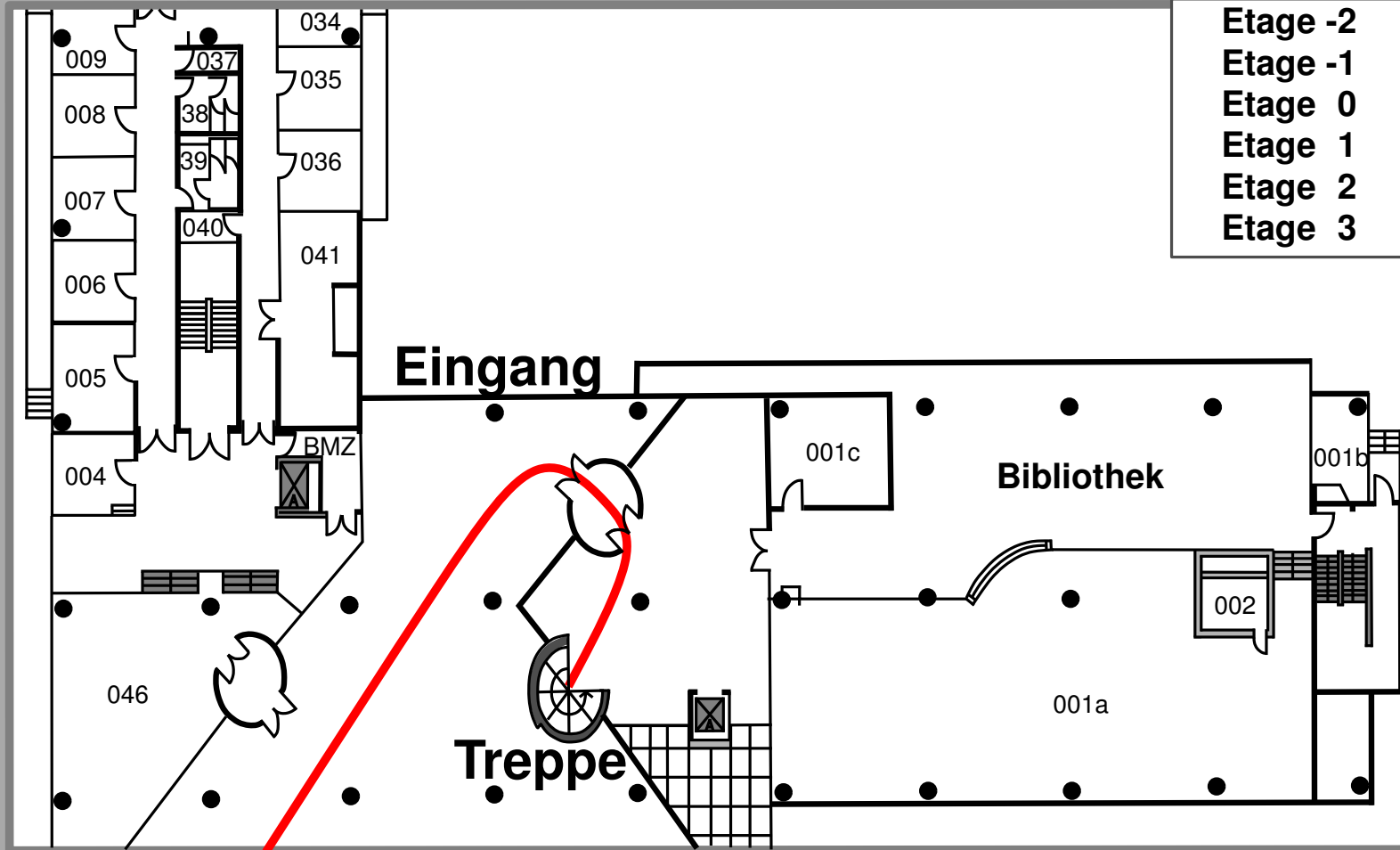



Campus-Routenplaner

From: **AUDIMAX**

To: **50.34, Raum 318**

Get directions

Etage 0

- Etage -2
- Etage -1
- Etage 0
- Etage 1
- Etage 2
- Etage 3

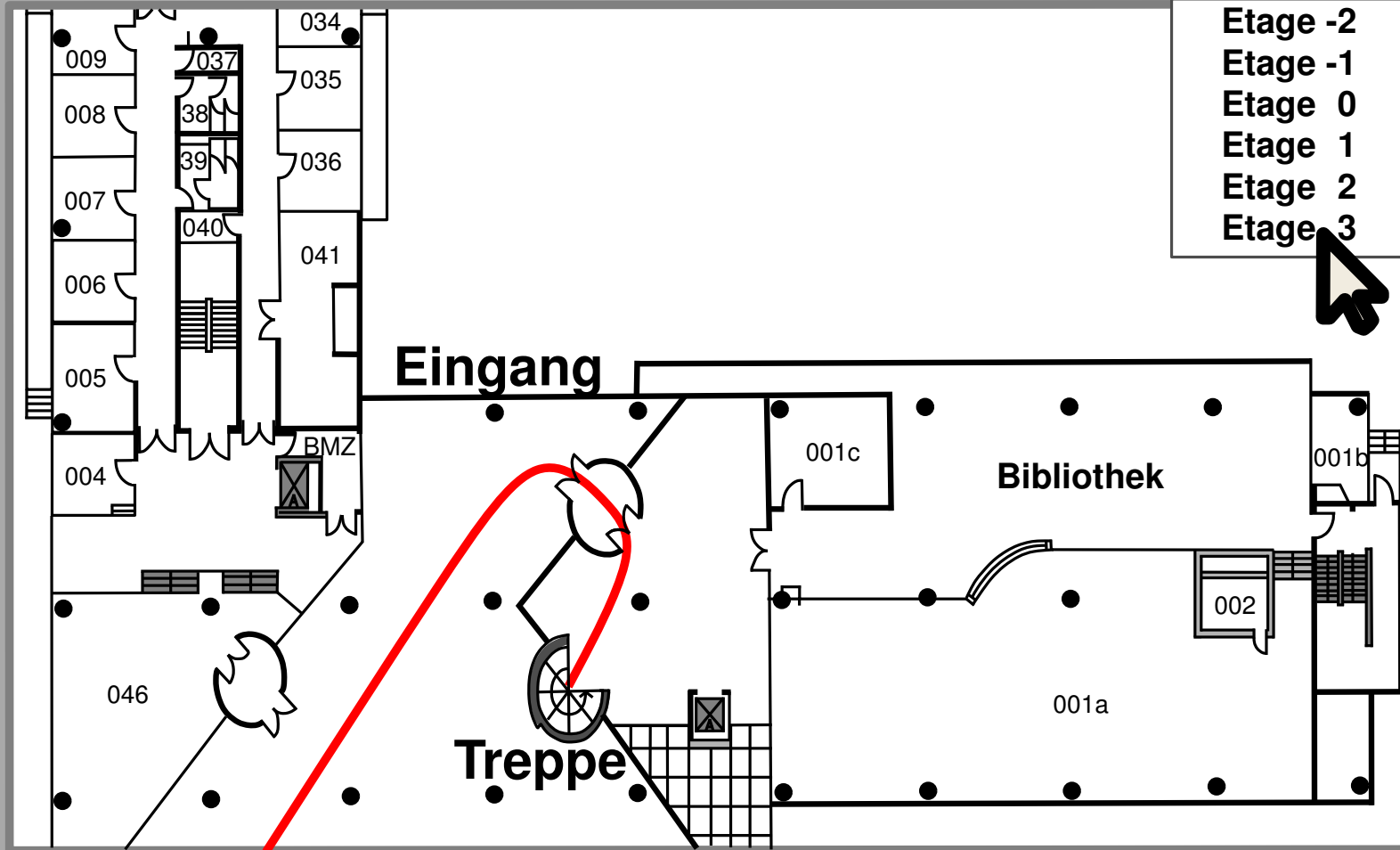



Campus-Routenplaner

From: **AUDIMAX**

To: **50.34, Raum 318**

Get directions

Etage 3

